

Unity Slim Smart Lock



The Yale Unity Slim Smart Lock is a keyless, secure, and user-friendly smart lock featuring a sleek, narrow escutcheon design and a multi-backset mortice lock, making it suitable for both aluminium and timber-framed doors. Its versatility makes it ideal for most hinged doors, including the increasingly popular aluminium front doors.

Like other locks in the Unity range, the Unity Slim can pair with the Unity Screen Door Lock using DualDoor™ Technology, providing the only integrated door and screen door smart locking solution available in the Australian market. This innovation completes a comprehensive smart lock offering for all hinged door types.*

Designed to withstand Australia's harsh weather conditions, the Unity Slim features a powder-coated diecast body and handle, along with a UV-protected screen for enhanced durability.

If you plan to install the Unity Slim on aluminium-framed doors, it is fully compatible with the Induro® 4-Point lift-to-lock system, providing four locking points—including the latch, deadbolt, and shoot bolts—when the handle is lifted. This not only enhances security but also ensures optimal seal compression, especially for large panel doors.

For timber-framed doors or retrofitting on Optimum and Induro 2-Point systems**, the lock is also available in a 2-Point configuration (without shoot bolts), making it an ideal choice for retrofitting all exterior hinged doors—from slender to wide stiles, and from timber to aluminium.

The Unity Slim Smart Lock has a built-in keypad for convenient key-free access at all times, and it is controllable by the Yale Home App. The Yale Home App allows you to lock and unlock your door, grant access to others, and keep track of visitor access,

all via your smartphone. You can grant users one-time access or access for a set time or a date range, avoiding any lost keys or having your keys stolen or copied. The auto-unlock feature unlocks your door as you approach, using varying technologies, including Bluetooth, Wi-Fi, and GPS, as well as the Yale Home App.

With Lift-to-Lock single action locking, the Unity Slim Smart Lock also cleverly incorporates smart locking as part of the Lift-to-Lock system. Not only does this mean that users can seal and multi-point lock in a single action, but for users not familiar with Lift to Lock, the system is a surefire way to ensure the lock is being used to its maximum security and sealing potential.

The door position sensor checks the status of the door and tells you if your door is securely closed and locked. This avoids inadvertently locking your door whilst the door is open. The Unity Slim Smart Lock can be upgraded with the Yale Connect Plus Hub 2. The Yale Connect Plus Hub 2 lets you access your lock remotely*** from wherever you are, allowing you to lock and unlock, change PIN codes, and see who has come and gone. The Yale Unity Slim Smart Lock comes with built-in Yale module, allowing your lock to work with the Yale Home app and Apple HomeKit straight out of box.

Works with your Smart Home

The Yale Connect Plus Hub 2 enables the 'Works with'**** ability, integrating into your Google Home, or Amazon Alexa.



* This product is only suitable for residential applications

**No door routing is required when replacing the current Optimum and Induro 2-points with the Unity Slim Smart lock 2pt. However, the strike plate must be replaced due to changing over projection to a lift bolt.

*** Yale Connect Plus Hub 2 is required and sold separately.

Unity Slim Smart Lock

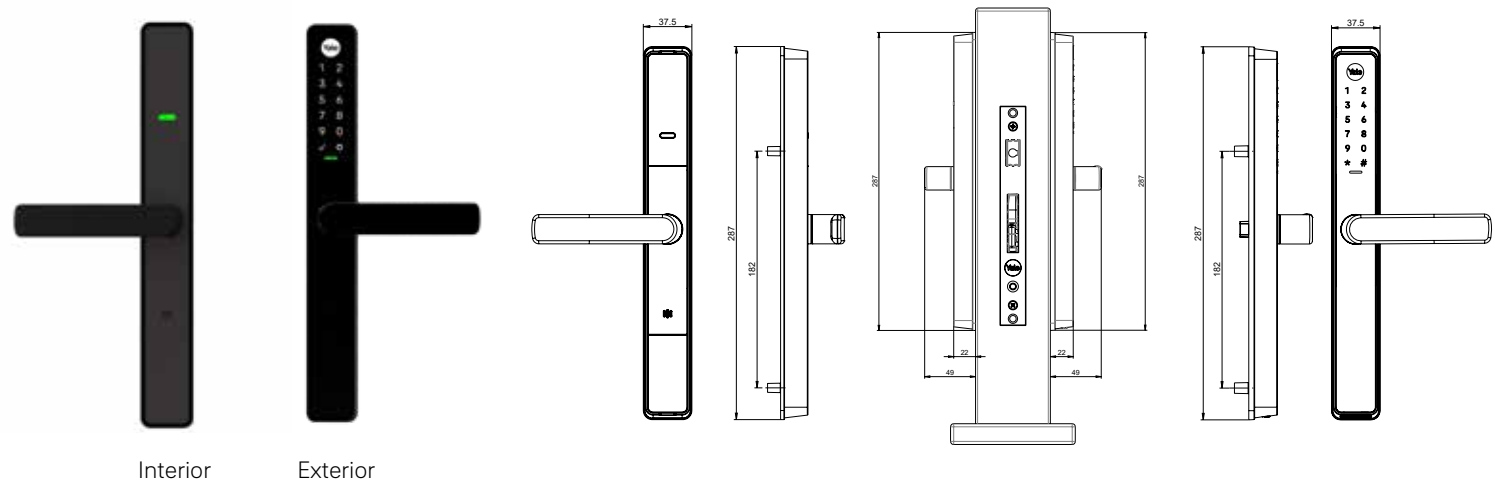

Features & Specifications:

- Multipoint Locking - Lift to Lock
- Total Control via Yale Home App
- Auto Lock/Unlock
- Fake PIN code to prevent the code from being exposed
- Remote locking/unlocking
- Tailor user access
- Smart Lock alerts
- 24/7 Lock Activity Trails
- 100% Key free
- DoorSense™ technology for Door position
- Emergency Power Supply
- UV Tested
- Smart Home Automation
- 6-digit keypad entry
- Durable mechanism and stainless-steel faceplate
- Available in different backsets with short and long throw options

Finishes

Matt Black

Technical Specifications	
Australian Standard	AS4145.2.2008 SL7 Security D7 Durability
Compliance	Regulatory Compliance Mark (RCM) for Australia and New Zealand
Locking Type	Multi-point locking with Digital furniture
Door Thickness	35-60mm
Mechanical Keys	No
Backset	30mm, 40mm and 50mm
Door Type	Aluminium or Timber
Handing	Suits left or right-hand opening doors
Finish	Matt Black powder coat
IP Rating	IP55
Operating Temperature	-15° - 55°C
Humidity	0-90%
Power	4 x AA Alkaline batteries (Included)
Battery Life on lock	Approximately 12 months
Low Battery Warning	20%
Volume Settings	Mute, Low, High
Use	Hinged Doors application for residential use.

Unity Slim Smart Lock

4-Point System, Typically Installed on Aluminium Door Frames

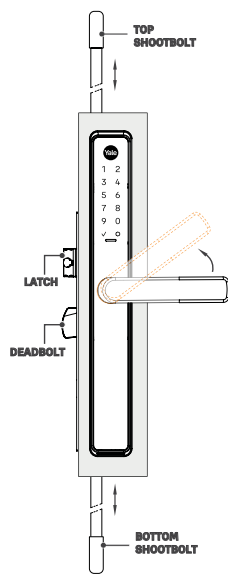

Enhances security but also ensures optimal seal compression

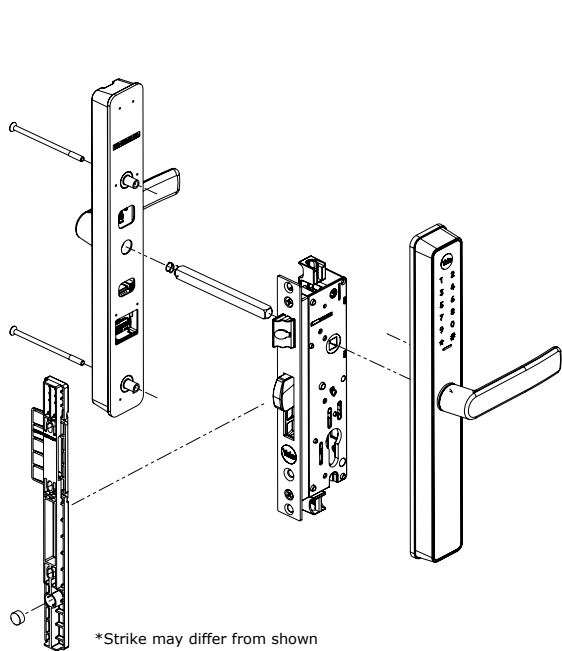

Trade Packs - Unity Slim 4 Point lock

Description	Part Number
UNITY HD USSL INDURO 30BS 4P S SS STRIKE	YURSSL0430400B
UNITY HD USSL INDURO 30BS 4P L SS STRIKE	YURSSL0431400B
UNITY HD USSL INDURO 40BS 4P S SS STRIKE	YURSSL0440400B
UNITY HD USSL INDURO 50BS 4P S SS STRIKE	YURSSL0450400B
UNITY HD USSL INDURO 50BS 4P L SS STRIKE	YURSSL0451400B

